



4" Clamped Butterfly Valve - left hand operated with TIR to handle and padlock facility. Contact parts manufactured in 316 stainless steel with Flexityt main seal.

Options - lockable handle. "Congealing cargo" version with semi-spherical closure plate. Version with high temperature seals. Pneumatic actuator available.

Arrange of 2" and 3" clamped valves is available.

Specification

Weight	4 Kg
Design Pressure (MAWP)	6 Bar (87 PSI)
Test Pressure	10 Bar (145 PSI)
Design Temperature Range	-40°C to 250°C (-40°F to 482°F)

The above information varies according to the valve specification.

Design approval by Lloyds Register of Shipping.
Approved to BS EN14432.

Range

Part No.	Description
468/7250B	Standard butterfly valve
468/7200BPN	Pneumatically actuated
468/725HTB	Fitted with high temperature seals
468/7260SHB	St.heated, semi-spherical closure plate

Associated Parts

Associated Parts	Part No.
CNAF/PTFE inlet gasket	5005-468
CNAF/PTFE outlet gasket	5005-469
Bolting kit (8 x bolts, nuts, washers)	468/1100
4" BSP outlet flange	468/8047
4" BSP blank cap with PTFE washer	10304PSC
4" NPT outlet flange	468/8049
4" NPT blank cap with PTFE washer	425/4000

Fitting Details

Part number: 468/7250B

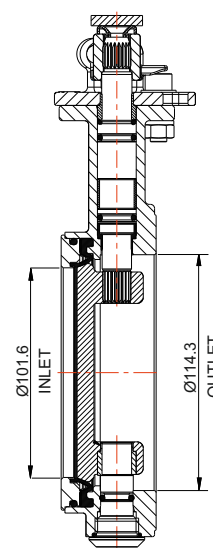
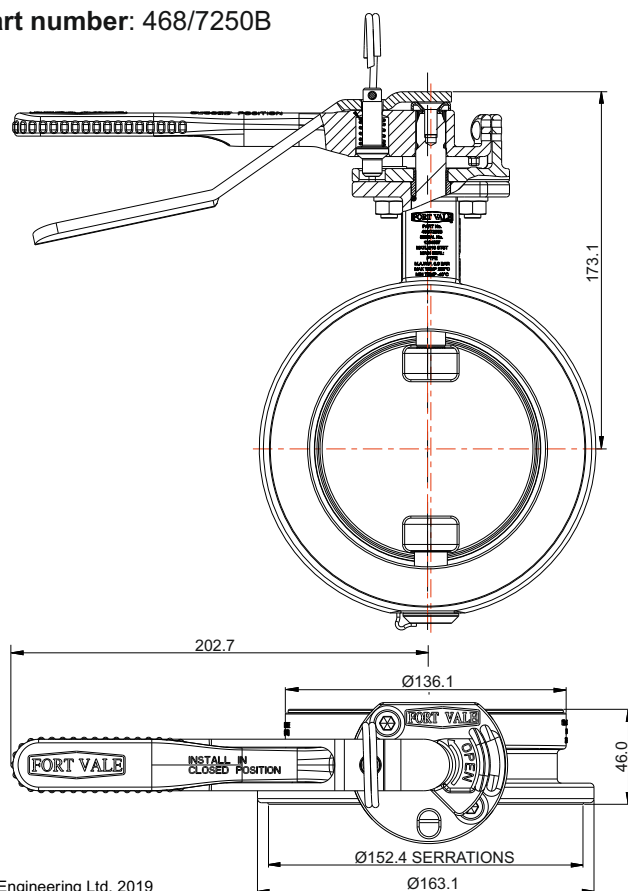

Parts drawing

FORT VALE®

Part number : 468/7250B

Item	Description	Part No.
1	Split ring	368/0011
2	Operating lever	368/9837
3	Countersunk bolt	5111-030
4	Washer	20370
5	Handle	368/0050
6	Handle spring	368/0012
7	Handle location pin	368/0010
8	Sockethead capscrew (2)	5111-148
9	Plain washer (2)	5113-005
10	Stuffing clamp	368/0040
11	PTFE stuffing clamp bush	368/0301 <input type="checkbox"/>
12	PTFE O ring	20363 <input type="checkbox"/>
13	Viton O ring (2)	20361 <input type="checkbox"/>
14	Spindle	368/0205
15	Split bearing	368/0039 <input type="checkbox"/>
16	PTFE bearing	368/0009HT/1 <input type="checkbox"/>
17	Closure plate	468/0400
18	PTFE bush	468/0035 <input type="checkbox"/>
19	High temperature seal	ORB614K1 <input type="checkbox"/>
20	PTFE O ring	5005-160 <input type="checkbox"/>
21	Lower spindle	468/0005
22	Spring washer (2)	5113-003
23	Full nut (2)	5112-001
24	Body	468/0200
25	Flexityt PTFE main seal	468/0030 <input type="checkbox"/>
26	Flexityt seal spring	468/0031
27	Nitrile O ring	5005-357 <input type="checkbox"/>
28	Seal clamp plate	468/0033

SEAL KIT

Part number **468/725SKB** contains all parts marked ☐