



MKII 80mm Internal Gas Relief Valve - Suitable for a pressure range of between 100 - 525.5 PSI (6.90 - 36.24 Bar). Contact parts manufactured in 304/316 stainless steel. Fitted with PTFE seals as standard.

Options - alternative flange drillings are available. Please see below for standard flange drilling patterns. Kalrez® seal optional.

Specification

Weight 21 Kgs *See Note
 Design Temperature -55°C to 80°C (-67°F to 176°F)

Note : Weight varies according to valve specification.

Design approval by Lloyds Register of Shipping and Russian Maritime Register of Shipping.

Test certificates supplied as standard. Please see separate data sheets for details on flow rates.

Tests may be witnessed and valves individually stamped by an independent inspectorate by arrangement.

Range

Part No.	Description
016/2XXX0	80mm Internal Gas Relief Valve, 250mm PCD flange drilling
016/2XXX5	80mm Internal Gas Relief Valve, 220mm PCD flange drilling

Associated Parts

Associated Parts	Part No.
Pressure gauges to suit various valve pressures	Various – please contact our Sales team
PTFE gasket (016/2XXX0)	5005-818
PTFE gasket (016/2XXX5)	5005-812

Fitting Details

Example shown : 016/2XXX5

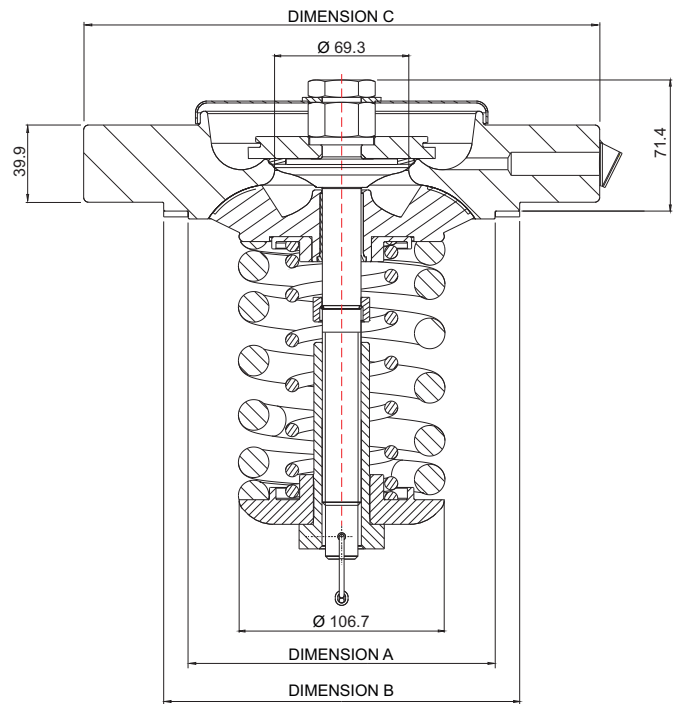
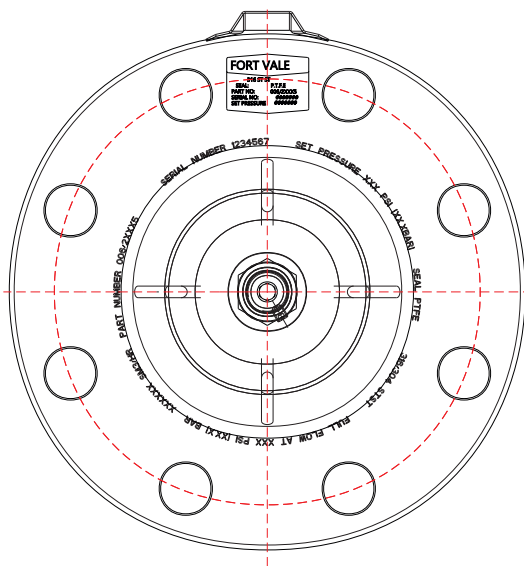

Part No.	Dimension A	Dimension B	Dimension C	Flange drilling pattern
016/2XXX0	168.4	202.9	299.8	8 holes 26.0 equi-spaced on a 250.0mm PCD
016/2XXX5	158.5	183.9	266.6	8 holes 26.0 equi-spaced on a 220.0mm PCD