



460mm Pendle Manlid Assembly - 6 point double skin manlid cover hinged to open to 135°. 6mm thick x 100mm deep straight neckring. Contact parts manufactured in 316 stainless steel. Stainless steel swingbolts with naval brass handnuts. Seal supplied separately.

Options - 0.7 Bar, 2 Bar, 3 Bar and 4 Bar version. 4 point, 6 point and 8 point assemblies. 120° opening. 100mm, 125mm, 150mm, 200mm and 250mm deep neckrings. Stainless steel swingbolts with stainless steel handnuts. Profiled and compensated versions. 304 Stainless steel and Carbon steel (SA516 G60) neckrings available.

**Fitting Details**

Example shown : 44C/6100100B

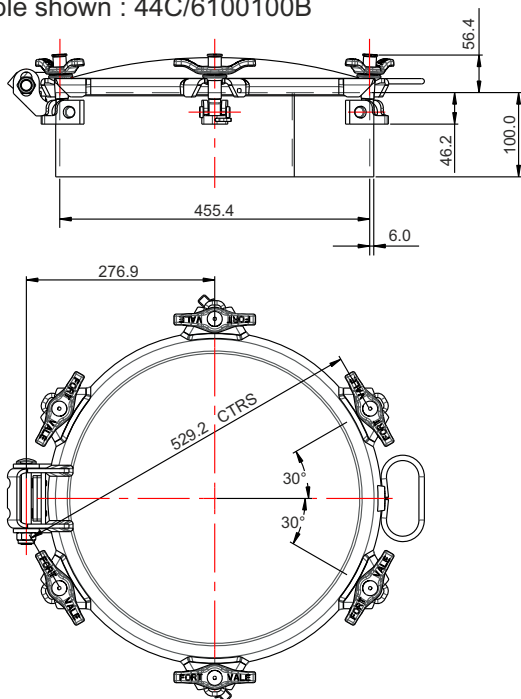

**Specification**

Weight 30 Kg \*NB  
 Design Pressure (MAWP) 4 Bar (58 PSI)  
 Test Pressure 6 Bar (87.5 PSI)  
 Design Temperature Range -40°C to 180°C (-40°F to 356°F)

Maximum handnut torque 118 Nm

\*NB Weight varies according to specification

**Range**

Part No.	Points	MAWP	Neckring	Material
4AC/4100100B	4	0.7 Bar	6mm x 100mm	St Steel
4AC/4100100BM	4	0.7 Bar	6mm x 100mm	Carbon Steel
4BC/4100100B	4	2 Bar	6mm x 100mm	St Steel
4BC/4100100BM	4	2 Bar	6mm x 100mm	Carbon Steel
43C/6100100B	6	3 Bar	6mm x 100mm	St Steel
43C/6100100BM	6	3 Bar	6mm x 100mm	Carbon Steel
44C/6100100B	6	4 Bar	6mm x 100mm	St Steel
44C/8100100B	8	4 Bar	6mm x 100mm	St Steel

The above table shows common configurations, other options are available.

**Parts drawing**

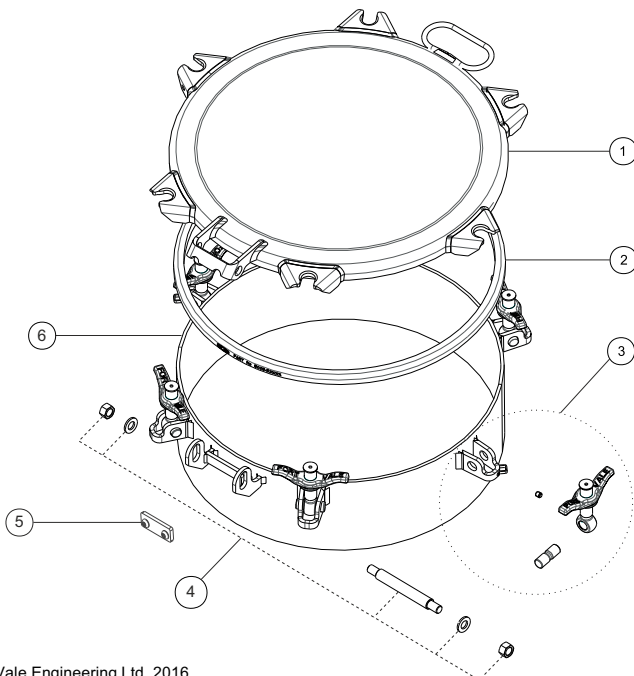

Item	Description	Part No.
1	Manlid *See Note 1	710/1200P
2	Seal - <i>supplied separately</i>	See MAN028
3	Swingbolt assembly (6) *See Note 2	496/X342
4	Hinge pin assembly	600/1060
5	Hinge kit *See Note 1	135B
6	Neckring	664/66100A

\*Note 1 : Part numbers vary according to specification

\*Note 2 :

X in swingbolt assembly part number denotes handnut material:

1 = naval brass

5 = stainless steel

E = low profile stainless steel/brass