

3" 45° Cleanflow Footvalve - inlet flange drilled 8 x 14mm holes equi-spaced on a 178mm PCD; outlet flange drilling as shown below. Footvalve body with 'Superseat' (alloy 625) seating area. All other contact parts are manufactured in 316 stainless steel. Fitted with a Forty poppet O ring.

**Options** - Available with alloy C276 seating area. A range of poppet seal materials and outlet flange drillings are available. A conical poppet and steam heating is available for congealing cargoes. The Cleanflow range includes 30°, 45°, 90° and 180° options. A range of bolting kits and outlet gaskets is available.

## Specification

Weight	9.87 Kg *See Note
Design Pressure (MAWP)	4 Bar (58 PSI)
Test Pressure	6 Bar (87 PSI)
Design Temperature	-40°C to 200°C (-40°F to 392°F)

\*Note Weight and dimensions vary according to valve specification.

Comparison tests between the Cleanflow and the Highlift footvalves conclude that there is a 38% increase in flow and a 27% reduction in discharge time.

Design approval by Lloyds Register of Shipping.

Approved to BS EN14433.

 Operating Instructions available - OPIN28 & OPIN47

## Fitting Details

Standard 3" 45° Cleanflow - Part No. 845/1200A

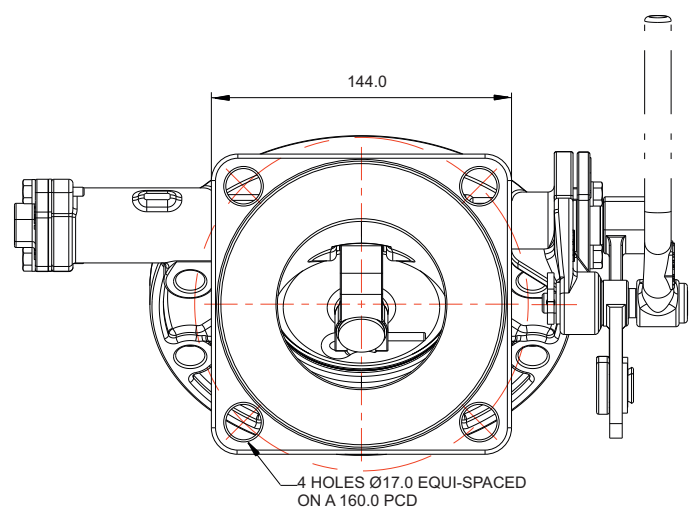
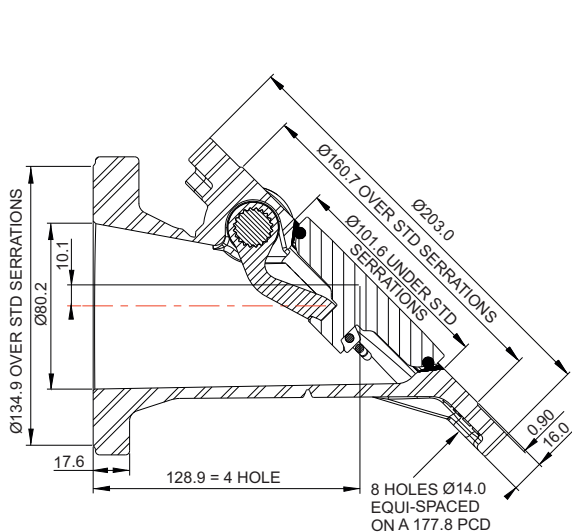

## Range

Part No.	Description
845/1200A	Superseat (alloy 625), 4 hole outlet
845/1200AHS	Alloy C276 seat, 4 hole outlet

## Associated Parts

Associated Parts	Part No.
Tank pad	324/9000
Stud kit	845/2040
Bolting kit – 4 hole outlet	311/3500
Bolting kit – 6 hole outlet	360/0300
Inlet gasket – 8 hole	5005-015
Outlet gasket	5005-049
Outlet gasket – 6 hole	5005-169